

1 DOWNLOAD THE APP

Download the INTIRE Workshop App from the Apple App Store (iOS) or Google Play Store (Android).



App Store



Google Play

2 CREATE AN USER ACCOUNT

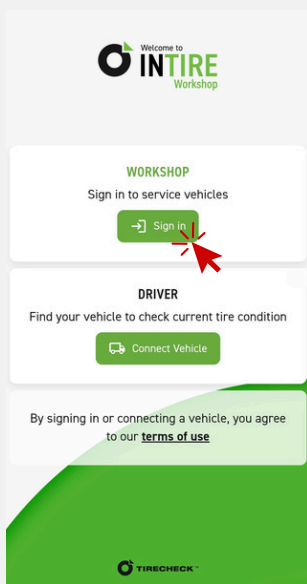

1. Click Login as a workshop.

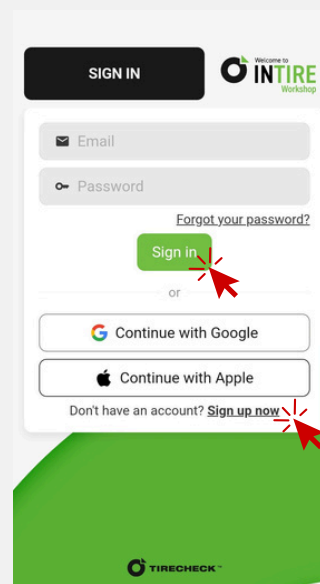

1. If you already have an account, log in.
2. If not, select "Register" to create a new account.

3 CONNECT A VEHICLE

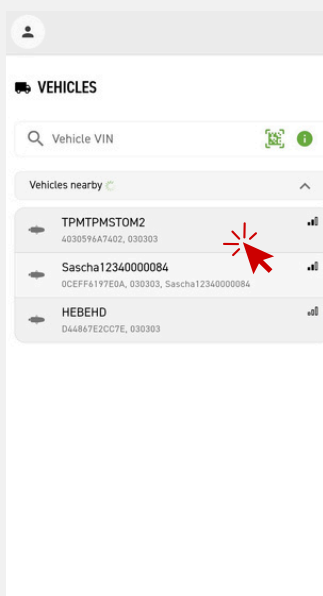

1. Nearby vehicles are automatically detected. Select a vehicle from the list and tap Connect. (Make sure the ignition is switched on.)

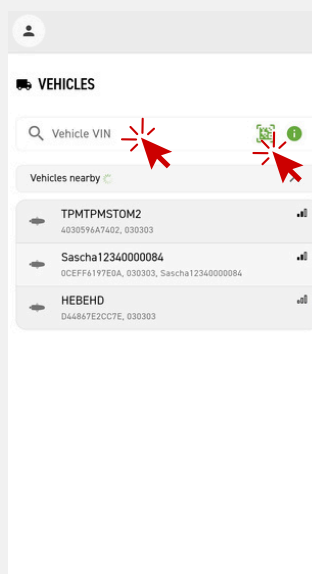

1. Alternatively, connect the vehicle by entering the Vehicle Identification Number (VIN) or by scanning the QR code.

4 PERFORM TPMS SERVICE

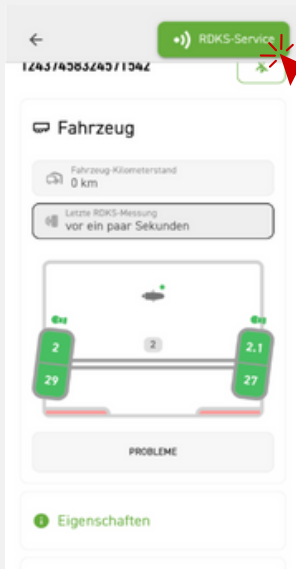

1. The vehicle layout and real-time data (tire pressure and temperature) are displayed.
2. Tap "TPMS Service" to start the process.

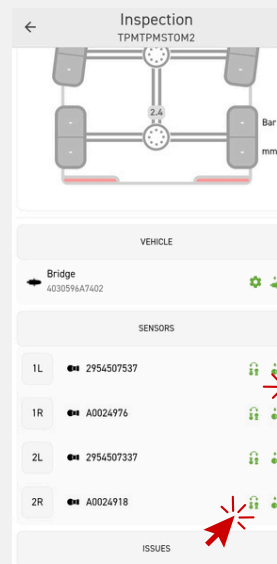

1. Overview of the bridge and sensors becomes visible.
2. Click the replace icon to exchange sensors.
3. The Sensor ID can be entered manually or scanned via QR code.
4. Sensors can be swapped between positions (e.g. front/rear or left/right) using the exchange arrows.

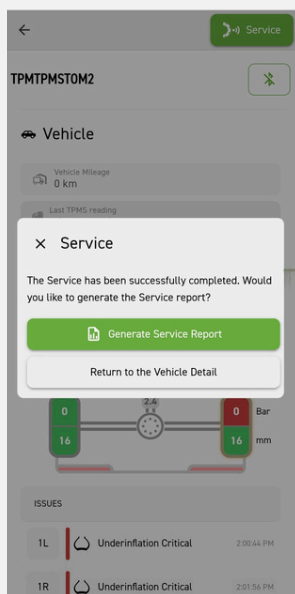

1. After finishing the service, select Complete.
2. All changes will be saved, and a service report can be generated (optional).
3. The vehicle overview will indicate if new firmware updates are available.



TECHNICAL SUPPORT

For technical questions or support needs.



+4973215504499



E-Mail:
support@tirecheck.com

Watch the instructions
videos here!



@TireCheck_TPMS

